

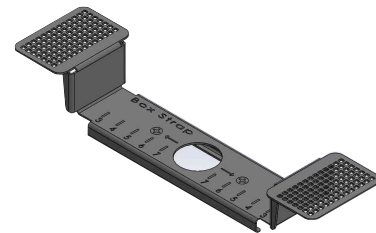

Reduce your carbon footprint by **2,843kg** of CO₂ across 200 apartments by Using our Alternative Bracket.

On average, every metric ton of steel produced led to 1.85 metric tons of CO₂ released into the atmosphere in 2020



Brand	Generic
Type	Telescopic Bracket
Dimensions	L 440 mm x W 26 mm x D 13.8 mm
Material Thickness	0.6mm
Material	Pre Galvanised steel
Packeging type	Bundle of 50 units
Weight	0.28kg
Steel reduction	N/A
CO2 emissions	0.518kg CO ₂

Brand	Box Strap
Type	Double Box
Dimensions	H 34 mm x W 50 mm x L 207 mm
Material Thickness	1mm
Material	Pre Galvanised steel
Packeging type	Bundle of 50 units
Weight	0.082kg
Steel Reduction	70.7%
CO2 emissions	0.152kg CO ₂

- On average, 35 brackets are used in every new build property in the UK construction industry.
- By using the Box Strap bracket, which is the lighter and smaller bracket, we are able to save approximately 12.81 kg of CO₂ emissions for each new build property in the UK
- Using the Box Strap bracket also has other impacts in the fight to lower CO₂ emissions that we haven't taken into consideration, such as:
 - Transportation: The lighter weight and the size of the bracket means that more pallets can be transported in one trip.
 - Storage: The smaller size of the bracket means that it takes up less space in storage
 - Packaging: The smaller size of the bracket also means that less cardboard is required for packaging, reducing the amount of waste generated and the associated CO₂ emissions.
 - Manufacturing in the UK: It contributes to lower CO₂ emissions, it reduces the need for long distance transportation, resulting in reduced carbon emissions associated with shipping and logistics.

Overall, using the Box Strap bracket not only reduces CO₂ emissions during production, but also has additional benefits that contribute to a more sustainable construction industry.